



Berkey®

WATER SYSTEMS

Instructions for Big Berkey®, Crown Berkey™, Imperial Berkey®, Royal Berkey® and Travel Berkey® water filtration systems

System Parts List

Berkey® Stainless Steel System

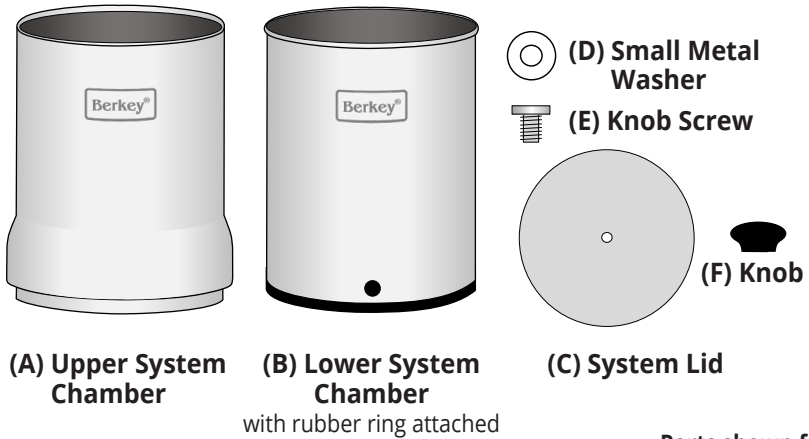

Spigot

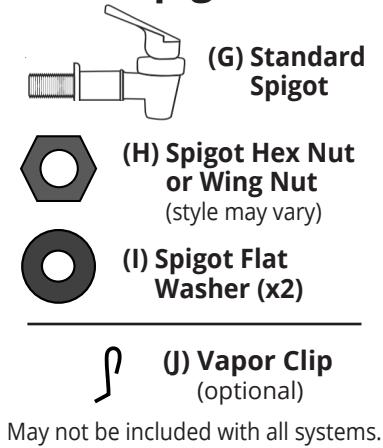

May not be included with all systems.

Black Berkey® Elements

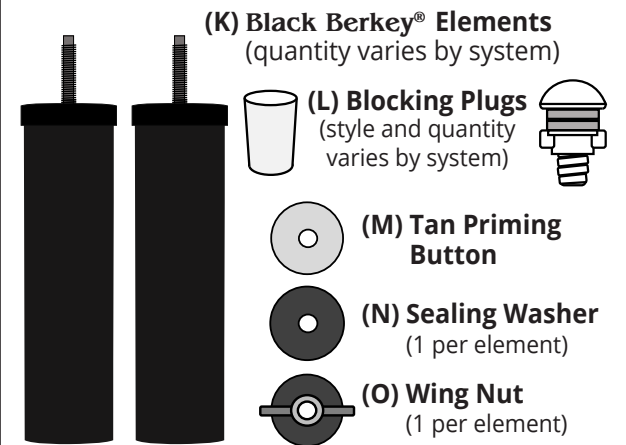

Parts shown for illustration only and are not to scale.

Failure to read, thoroughly understand, and follow all instructions may result in injury, water damage, or voiding of the warranty! It is the assembler's responsibility to make sure all components are properly assembled and installed using the instructions provided. While your Berkey® System should not have any leaking problems, there is always the chance that a leak might occur due to being improperly assembled or perhaps a faulty part. In an overabundance of caution, we recommend that for the first 24 hours the filled system be placed in an area wherein if such a leak were to occur, the resulting spillage would not damage anything.

System Assembly

Tools you'll need: standard screwdriver (not included). We recommend setting up your system on a countertop or other waterproof surface.

- Wash your hands, stainless steel chambers and spigot before assembly to reduce the chances of contaminating the system's components.
- Be sure to keep all parts and original packaging in the unlikely event that your system needs to be returned to the manufacturer.

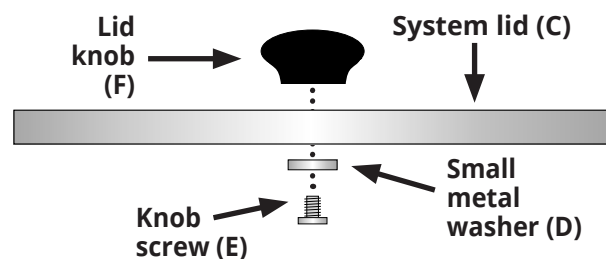

1. Attach Knob to Lid

Fit knob onto lid by inserting the knob screw up through the washer into hole in the underside of lid, then screw on the knob.

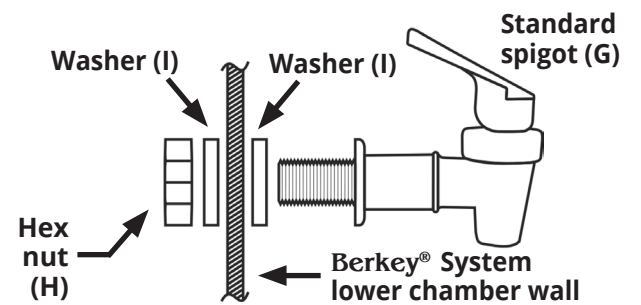

2. Assemble Spigot

To assure a proper seal, place one washer on stem of spigot. Insert spigot into system and turn spigot counterclockwise to the 9 o'clock position. Then, place the other washer on stem inside of the system, then the nut, and hand-turn nut until it is tight while holding spigot at the 9 o'clock position. Then, hold nut in place and rotate spigot clockwise until spigot is upright.

Berkey® System upper chamber (A)

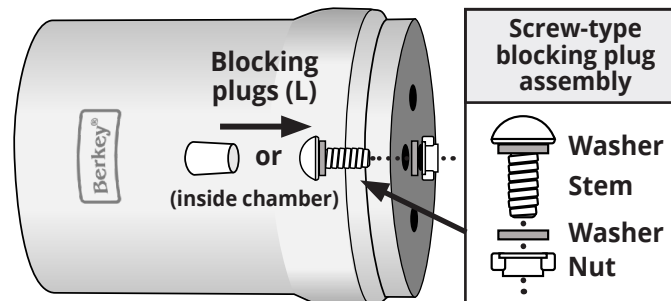

3. Insert Blocking Plugs

Use blocking plugs to fill remaining open holes in the upper chamber where you will not be installing Black Berkey® Elements. For **push-in blocking plugs**, simply press plugs into holes from inside the upper chamber (smaller end first). For **screw-type blocking plugs**, place one washer on threaded stem, and insert plug (stem) through one of the holes inside the system's upper chamber. Place other washer on the threaded stem outside of system, then the nut. Hold plug securely with one hand inside system, and hand-turn nut on outside of system until snug. Do not over-tighten. Repeat for remaining plugs.

4. Install the Vapor Lock Clip

Climate, elevation and other factors can create a tighter fit, preventing air flow between chambers, which slows down or prevents water flow (a natural phenomenon known as vapor lock). To prevent vapor lock, create air flow by placing clip on edge of lower chamber, making sure that the long portion of the airlock clip is hanging inside of the lower chamber.

Note: All systems may not include a vapor lock clip. If you experience vapor lock, please contact our Customer Service department to obtain a clip. For customers outside the United States, please contact a local Authorized Berkey® Dealer.



5. Prime the Black Berkey® Elements

Priming uses water to displace air out of the elements' pores, ensuring that water can flow freely. **Elements will not operate properly if they are not primed.** We recommend setting up your system on a countertop or other waterproof surface. If process dust is present, wipe it off with a Scotch-Brite® pad under cold running water.

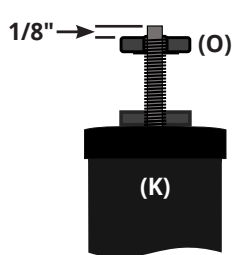

1. Loosen wing nut (O) on Black Berkey® Element (K) stem until the top of wing nut (O) reaches the top of stem's threads (about 1/8" from top end of stem).

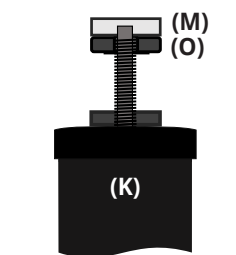

2. Place tan priming button (M) on top of wing nut (O). Top of tan priming button should be slightly higher than the top of the stem.

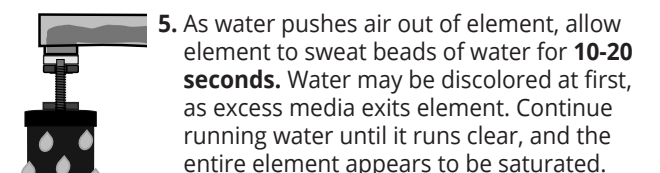
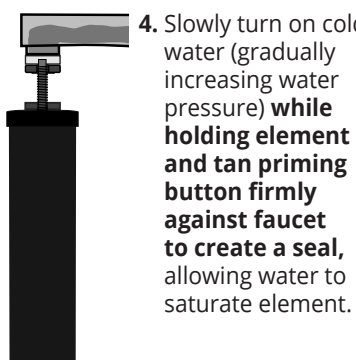
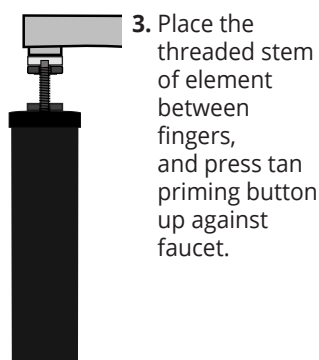

The element is now primed and ready for installation. Repeat steps 1-5 at left for your remaining elements.

Tip: Your Black Berkey® Elements will be wet after priming them—we recommend placing your elements in a clean bowl or sink while assembling the rest of your system.

6. Install Primed Elements In The System

1. Remove wing nut from threaded stem while leaving sealing washer on **Black Berkey®** Element.
2. Place threaded stem, with sealing washer attached, into the hole in the interior base of upper chamber.
3. Secure element in the base of the chamber by screwing wing nut onto threaded mount until hand-tight. **Caution: hand tighten only. Over-tightening wing nut can strip the nut's threads, which could cause the system to leak.** Repeat these 3 steps for remaining elements.
4. With elements in place, carefully place upper chamber onto lower chamber. Your system is now assembled and ready to use.

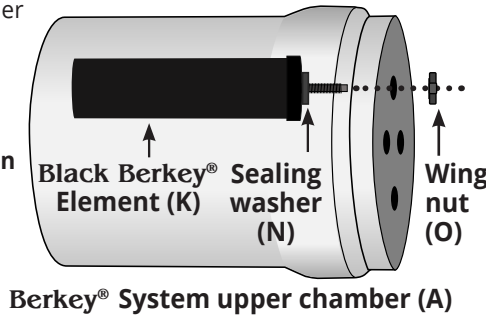

Alternate/Off-Grid Priming Methods

When using the system off-grid or traveling where treated water is not available, we strongly recommend using the **Black Berkey Primer™** (sold separately), a handheld priming pump that makes the elements easy to prime without the need for faucets or hose connections. **Black Berkey Primers™** are available from Authorized **Berkey®** Dealers worldwide.

Black Berkey® Elements may also be primed using a bottle of filtered water. Have one person hold the element, with the priming button attached and facing upward. Have a second person press the mouth of the bottled water against the priming button and squeeze until water is forced through entire exterior wall of element and it begins to sweat beads of water.

Using Your System

Always use only the cleanest freshwater source available. **Use of softened water or salt water can clog the filter's pores and will void your warranty.**

Avoid placing your system in direct sunlight or near a heat source such as a stove, indoor heater, etc.

1. Fill upper chamber with cold or room temperature water. **DO NOT use hot or boiling water.**
2. Place lid on system. Allow water to filter into lower chamber.
3. Open the spigot to completely empty the lower chamber, and discard water. If water is slightly discolored due to any remaining particulate, do not be concerned—simply repeat steps 1-3 in this section as many times as needed until dispensed water is clear.
4. Your system is now ready to use. Refill upper chamber with water.

Notes:

- It may take up to 15 minutes for elements to begin dripping water from the upper chamber into the lower chamber.
- Maximum flow rate will be achieved after the initial 12-24 hours of use as micro air pockets within the elements are replaced with water.
- It is normal to have a few inches of water left in the upper chamber when using the system, as it is gravity fed and the water cannot process through the bottom of the element.

Assembly Verification* (Red Food Coloring Test)

This simple test verifies that your system has been assembled correctly, and that there are no internal leaks in your system. We recommend this test be done after the first assembly of this system, after removal or replacement of **Black Berkey®** Elements, or the first use after drying and storing the elements for an extended period of time. **Ensure that you do not have Berkey PF-2™ Fluoride and Arsenic Reduction Elements installed in the system when performing this test.**

1. Add up to 1 teaspoon of artificial **red** food coloring (must be red) for every gallon that your **Berkey®** System can hold into the upper chamber. We recommend McCormick's red food coloring or any artificial food coloring. Acceptable food color ingredients include water, propylene glycol, FD&C Red 40 and FD&C Red 3, and propylparaben. **Avoid using food coloring that is not red, or contains citric acid, sodium benzoate or natural ingredients such as beet juice, turmeric, etc. Using organic food colorings will result in a false failed test (stating that your system is not sealed correctly).**
2. Place a cup under spigot and drain water. If dispensed water does not have a red or pink hue, this indicates that the elements are sealed and system has been assembled correctly.

***Note: This test does not demonstrate the complete reduction of all possible water contaminants; it is meant to confirm that the system was assembled as intended.**

If water drained from system has a red or pink hue during the assembly verification test, repeat the procedure again in this manner to determine the source of the leak:

1. Place the upper system chamber only (with **Black Berkey®** Elements installed) on top of same-sized cups or jars, each positioned so that an element can drip water into it. This will help you identify which blocking plug or element may be leaking.
2. Fill upper chamber with water and red food coloring as directed above.
3. Allow system to filter water. Check the color of water expelled from the elements. If water color is clear, your system is ready to use. If red dye is still present, reinstall the element(s) or blocking plug(s) where leaking occurs and re-run test.
4. If system continues to fail the test, contact our Customer Service department for assistance.

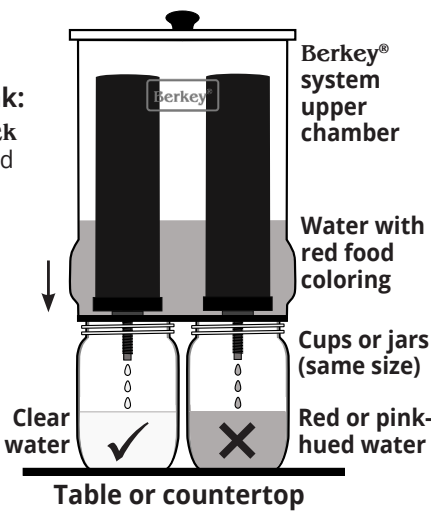

Precautions

- **Avoid placing your system in direct sunlight or near a heat source such as a stove, indoor heater, etc.** Excessive heat can create conditions that could facilitate microbiological growth (mold, biofilm, bacteria, etc.) inside the upper chamber, where untreated (and possibly contaminated) water is poured into the system.
- **When lower chamber is partially filled, be cautious not to overfill upper chamber,** as this could cause lower chamber to overflow.
For example: if the lower chamber is 1/3 full, the upper chamber can be refilled by 2/3. If the lower chamber is 1/2 full, the upper chamber can be refilled by 1/2, etc.
- **Never allow wet Black Berkey® Elements to freeze**—exposure to freezing temperatures can expand the water into ice, which may damage the elements and cause them to crack or break. Allowing elements to freeze will void your warranty.

Black Berkey® Element Storage

If you are going to be leaving the system unattended for 4-15 days and want to reduce the necessity of re-priming the elements, remove the elements from your system and place them in a sealable plastic bag (gallon-size or larger) while elements are still damp (this allows the elements to stay wet, making priming unnecessary). Then, place the elements in your refrigerator where they will not freeze. When ready, thoroughly rinse elements under cold water, then reinstall them in your system.

For longer-term storage, we recommend completely drying the elements first. Ensuring they are bone-dry (zero moisture) before storing them long-term helps prevent any potential microbiological growth (mold, biofilm, bacteria, etc.). Shake excess water from elements, then air-dry by leaving them on a windowsill or other sunny location for 1-3 days until completely dry.

Once elements are bone-dry (zero moisture), store them in a sealable plastic bag (gallon-size or larger)—this prevents elements from absorbing odors. When you are ready to re-use your elements, clean them by scrubbing the outside with a stiff brush or a Scotch-Brite® pad under cold running water. Then re-prime the elements before putting them back in your system.

Alternatively, you can use a **Black Berkey Primer™** (sold separately) which assists in both priming and purging. Purging speeds up the drying process by pushing water out of the element before you place them in the sun or air dry to complete the process. Note: when purging, valves on the **Black Berkey Primer™** must be reversed.

System Troubleshooting

After prolonged use, flow rate may decrease significantly. To improve flow rate:

1. Slow flow rate could be caused by vapor lock. Insert vapor lock clip, if supplied. See page 1, assembly step #4.
2. Carefully remove the elements from the upper chamber and gently scrub them with a stiff brush or Scotch-Brite® pad under cold running water (never apply soap or other cleaning agents to your **Black Berkey®** Elements). Re-prime elements, and reinstall them inside the upper chamber.
3. Place upper chamber back onto lower chamber, then perform the Assembly Verification process (Red Food Coloring Test). Your system is ready to use.

New Millennium Concepts, Ltd. Limited Warranty

New Millennium Concepts, Ltd. warrants their product against defects in materials or workmanship during ordinary consumer use. This Limited Warranty does not cover product issues caused by any other reason, for the time periods and conditions set forth below when purchased directly from an Authorized **Berkey®** Dealer. New Millennium Concepts, Ltd. shall not be held liable for incidental or consequential damage to personal property from, but not limited to, a defective unit, improper use, abuse, accident, or neglect, etc. It is the customer's responsibility to prevent misuse of the system and to replace parts, when, due to the natural course of wear and tear, they must be replaced. To obtain warranty service, you must provide a dated receipt for the product and may be responsible to pay for any shipping charges incurred to return the product to New Millennium Concepts, Ltd. when required. This warranty will not apply to units which have been used for purposes not intended, which have been altered so as, in the manufacturer's judgment, to adversely affect its performance. This warranty is for the original retail purchaser only, and cannot be transferred. For a period not to exceed the specified warranty coverage from the date of receipt of the product by the original purchaser on the original invoice, New Millennium Concepts, Ltd. will, solely at its discretion, replace said product or component that New Millennium Concepts, Ltd. deems is not functioning properly during the stated warranty period. The laws of the state of Texas, USA will govern any disputes regarding this warranty or claim made. This warranty, which is given expressly in lieu of all warranties, expressed or implied, or merchantability and fitness for a particular purpose, constitutes the only warranty made by New Millennium Concepts, Ltd. This warranty applies only to products manufactured or exclusively distributed by New Millennium Concepts, Ltd. and its Authorized **Berkey®** Dealers, and does not apply to extended warranties offered by some Authorized **Berkey®** Dealers. **Berkey® System Housing:** **Berkey®** System upper and lower chambers including lids, excluding orders for factory-blemished systems, are covered under a one-year warranty. The warranty period begins from the date of receipt of the product by the original purchaser on the original invoice. **Black Berkey® Elements:** **Black Berkey®** Elements are covered under a two year limited prorated warranty, calculated in six-month intervals. Warranty period begins from the date of receipt of the product by the original purchaser on the original invoice. **Included spigot and accessories that are sold separately** are covered under a six-month warranty. The warranty period begins from the date of receipt of the product by the original purchaser on the original invoice.

Questions About Using or Assembling Your Berkey® System?

Instructional Videos • Product FAQs • Support Via Email or Live Chat
support.berkeywater.com

Phone: (888) 803-4438 Monday - Friday 9AM - 5PM CST
Holiday hours may vary.